



Efficiency and reliability, every day!

ELECTRIC WATER HEATERS

Fast and efficient
domestic hot water
supply!



ELECTRIC WATER HEATERS AND ELECTRIC WATER HEATERS WITH HEAT EXCHANGER

Meet the needs for fast and efficient hot water supply. They are specially designed for durability in areas with high level of water hardness.

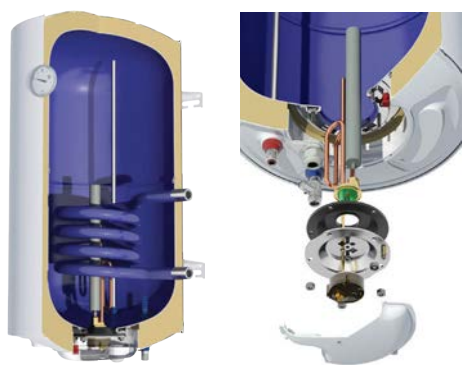

**ELECTRIC WATER HEATER
WITH PLASTIC CAPS**

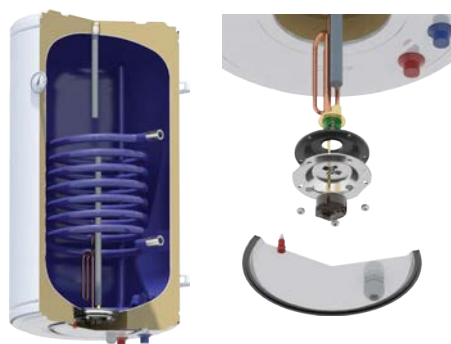

**ELECTRIC WATER HEATER
WITH METALIC CAPS**

*ALSO AVAILABLE WITH
HEAT EXCHANGER FOR CONNECTION
WITH AN AUXILIARY ENERGY SOURCE*

TECHNICAL SPECIFICATIONS

STEEL AND ENAMEL WATER TANK (GLASS)

- **Water storage tank** made of cold rolled steel. The thermal tank is shaped in special patterns by robot welding process, thus achieving:
 - A) Perfect enamel application,
 - B) Avoid the deformation of the internal tank as well as the enamel erosion in case of high pressure.
- **Anti-corrosion internal layer of enamel** baked at 860°C, according to DIN 4753 standard, for protection against electrolysis. The enameling is done in our own high tech industrial facilities. The water tanks are checked individually upon exit from the enameling unit assuring the top quality of the enamel.
- **Hot water outlet (consumption):** ½" BSP male threaded pipe with internal stainless steel tube and with plastic adapter.
- **Cold water inlet (supply):** ½" BSP male threaded pipe with special shaped plastic divider, for even water stratum.
- **10 bar non-return valve** for safe and controlled hydraulic pressure relief.
- **Steel pressed neck for the heating element** without welding, with internal incision for easy and quick heating element installation, no need for special tools (locknuts). Extraction and re-installation of the heating element in less than one minute.
- **Full bodied gasket** for sealing the heating element from the thermal tank, thus protecting the heating element flange from electrolysis and corrosion.
- **Heating element** rated according to the country of destination local regulations. It can be pulled away from the flange*.
- **Heat exchanger** with ¾" BSP female threaded pipe ends, made of steel pipe, large exchange surface for use of the heating produced by central heating systems during the winter (optional).
- **Cathode protection** by magnesium anode for effective internal protection against corrosion and mineral deposits caused by electrolytic reactions.
- **Internal adjustable thermostat** with bipolar protection and auxiliary fuse.
- **Protective cover for the electrical section** designed for easy access. It locks with just one screw. Ventilation holes specially designed for safe water vapor aspiration.
- **Sealed entry** of the heating element connection cable, with a rubber collar on the cable.
- **Operation indication light.**
- **Thermal insulation:** ecological high-density (40kg/m³) expanded polyurethane ensures minimum heat loss, maintaining the hot water temperature.
- **Insulation thermal conductivity:** $\lambda=0.023$ W/m K (DIN 56612, measured at 10°C) (DIN EN ISO 845, DIN 53 421, ISO 4590, DIN ISO 2796).
- **External housing** with electrostatically robotized painted or galvanized pre-painted steel for protection against corrosion.
- **Side Plastic (Ø430) or Metallic (Ø560) caps**
- **Thermometer**
- **Mounting** vertical, horizontal or floor.
- **Packed in carton boxes** for safe and easy storage - transportation.
- **CE Marking** compliance with European health, safety & environmental protection legislation

SPECIFICATIONS (COMMON FOR ALL TYPES)

| | |
|-------------------------------|--------|
| OPERATION VOLTAGE | 230 V |
| MAXIMUM OPERATING PRESSURE | 10 bar |
| TEST PRESSURE | 15 bar |
| MAXIMUM OPERATING TEMPERATURE | 90°C |

ENERGY LABEL (ERP)



* The electric power varies between 1200W and 4000W depending on the EWH capacity.
All electrical components carry the CE marking according to EN 60335-1 and EN60335-2-21 standards.

TECHNICAL DETAILS FOR: ELECTRIC WATER HEATERS AND ELECTRIC WATER HEATERS WITH HEAT EXCHANGER WITH PLASTIC CAPS

8 - 150lt

| ELECTRIC WATER HEATERS | REAL CAPACITY | WEIGHT | ELECTRIC WATER HEATERS WITH HEAT EXCHANGER | HEAT EXCHANGER SURFACE | HEAT EXCHANGER POWER (80°C) | CONTINUOUS FLOW RATE (ΔT 35°C-80°C) | HEATING TIME (ΔT 45°C-80°C) | WEIGHT |
|------------------------|---------------|--------|--|------------------------|-----------------------------|-------------------------------------|-----------------------------|--------|
| 8lt | 6,9lt | 6kg | - | - | - | - | - | - |
| 20lt | 17,6lt | 11kg | - | - | - | - | - | - |
| 40lt | 36,4lt | 15kg | - | - | - | - | - | - |
| 50lt | 45,6lt | 18kg | - | - | - | - | - | - |
| 60lt | 55,6lt | 19kg | 60lt | 0,25m ² | 9,3kW | 228lt/h | 11min | 23kg |
| 80lt | 74,4lt | 20kg | 80lt | 0,25m ² | 9,3kW | 228lt/h | 17min | 24kg |
| 100lt | 90,9lt | 25kg | 100lt | 0,25m ² | 9,3kW | 228lt/h | 28min | 29kg |
| 120lt | 107,9lt | 30kg | 120lt | 0,25m ² | 9,3kW | 228lt/h | 36min | 34kg |
| 150lt | 149,2lt | 49kg | 150lt | 0,50m ² | 14,8kW | 363lt/h | 38min | 55kg |

TECHNICAL DETAILS FOR: ELECTRIC WATER HEATERS AND ELECTRIC WATER HEATERS WITH HEAT EXCHANGER WITH METALIC CAPS

150 - 200lt

| ELECTRIC WATER HEATERS | REAL CAPACITY | WEIGHT | ELECTRIC WATER HEATERS WITH HEAT EXCHANGER | HEAT EXCHANGER SURFACE | HEAT EXCHANGER POWER (80°C) | CONTINUOUS FLOW RATE (ΔT 35°C-80°C) | HEATING TIME (ΔT 45°C-80°C) | WEIGHT |
|------------------------|---------------|--------|--|------------------------|-----------------------------|-------------------------------------|-----------------------------|--------|
| 150lt | 149,2lt | 60kg | 150lt | 0,50m ² | 14,8kW | 363lt/h | 38min | 55lt |
| 200lt | 190,1lt | 72kg | 200lt | 0,50m ² | 14,8kW | 363lt/h | 45min | 66lt |

Upon request, we undertake the manufacturing of customized (in terms of product dimensions) electric water heaters, maintaining the specifications of our standard product.

DIMENSIONS (in cm)

ELECTRIC WATER HEATERS AND ELECTRIC WATER HEATERS WITH HEAT EXCHANGER WITH PLASTIC CAPS

8 - 150lt

VERTICAL TYPE

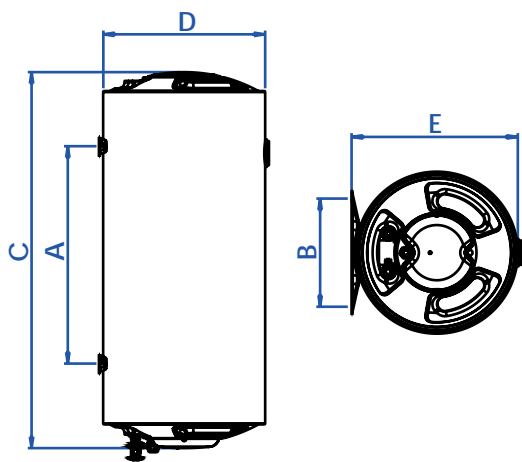

HORIZONTAL TYPE

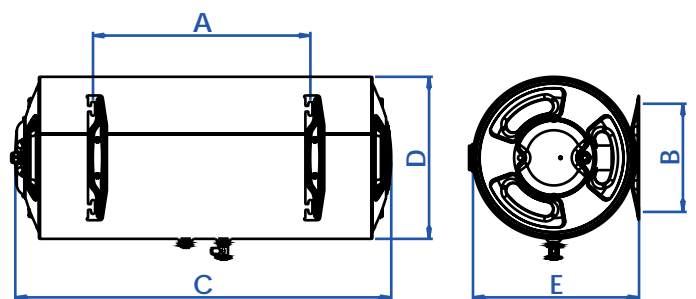

FLOOR TYPE

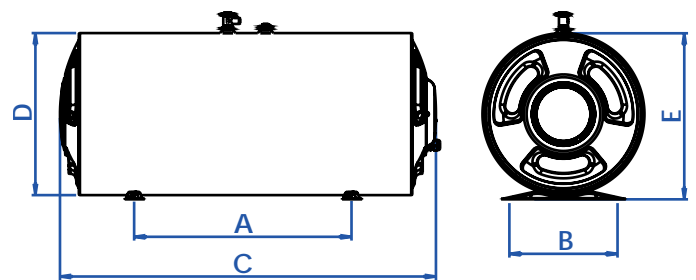

| TYPE | A | B | C | D | E |
|-------|-----|----|-----|----|----|
| 8lt | 23 | 19 | 43 | 23 | 24 |
| 20lt | 25 | 26 | 51 | 32 | 33 |
| 40lt | 15 | 26 | 55 | 43 | 44 |
| 50lt | 18 | 26 | 61 | 43 | 44 |
| 60lt | 27 | 26 | 69 | 43 | 44 |
| 80lt | 43 | 26 | 84 | 43 | 44 |
| 100lt | 58 | 26 | 99 | 43 | 44 |
| 120lt | 73 | 26 | 119 | 43 | 44 |
| 150lt | 105 | 26 | 145 | 43 | 44 |

DIMENSIONS (in cm)

ELECTRIC WATER HEATERS AND ELECTRIC WATER HEATERS WITH HEAT EXCHANGER WITH METALIC CAPS

150 - 200lt
HORIZONTAL TYPE

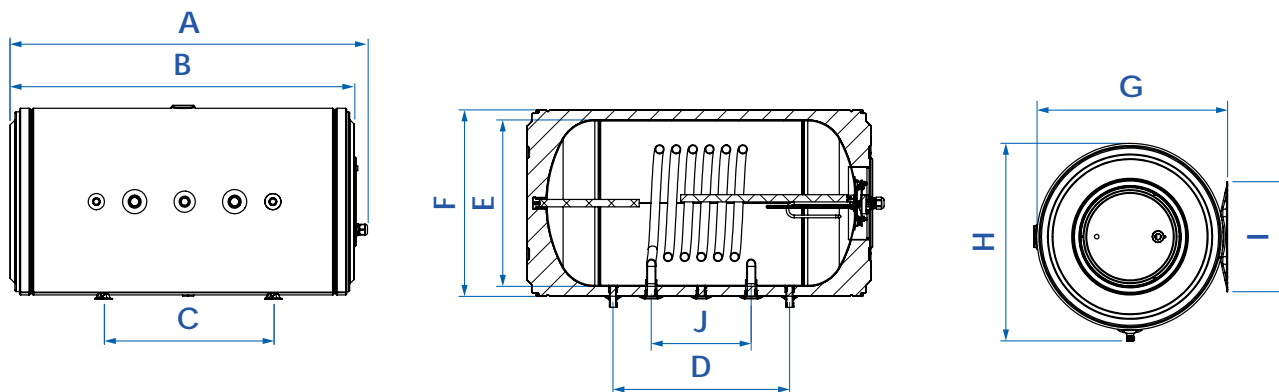

| TYPE | A | B | C | D | E | F | G | H | I | J |
|-------|-----|-----|----|----|----|----|----|----|----|----|
| 150 L | 107 | 103 | 51 | 53 | 50 | 56 | 57 | 59 | 33 | 30 |
| 200 L | 128 | 124 | 72 | 74 | 50 | 56 | 57 | 59 | 33 | 30 |

ELECTRIC WATER HEATERS AND ELECTRIC WATER HEATERS WITH HEAT EXCHANGER WITH METALIC CAPS

150 - 200lt
VERTICAL TYPE

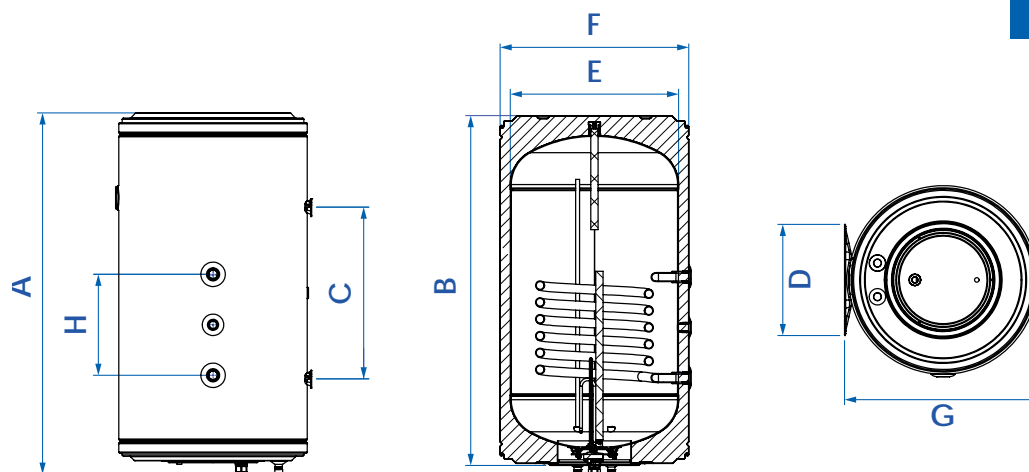

| TYPE | A | B | C | D | E | F | G | H |
|-------|-----|-----|----|----|----|----|----|----|
| 150 L | 107 | 104 | 51 | 33 | 50 | 56 | 58 | 30 |
| 200 L | 128 | 125 | 72 | 33 | 50 | 56 | 58 | 30 |



Efficiency and reliability, every day!

11/21

ELECTRIC WATER HEATERS

NOBEL INTERNATIONAL EAD

SOLAR WATER HEATING SYSTEMS INDUSTRY

48 Vitosha Blvd., Elin Pelin 2100 - Sofia Region, Bulgaria
Tel.: +359 2 4210232 email: info@nobel.bg

www.nobel.bg

